

RIGID AXLE





UNBRAKED RIGID AXLE

Load capacity up to 1800 kg

Product can be used for:

- utility trailers

Standard surface treatment: hot dip galvanization

Load capacity: 500 kg - 1800 kg

Axle body type:

- tube
- square tube

Bearing type: compact ball bearing with long lifespan,
taper roller bearing,
compact taper roller bearing

Includes:

- axle with type table
- hub or drum brake

New design!

Solid axle with additional protector cup
It protects the seal against stones
and debris in a harsh environment.

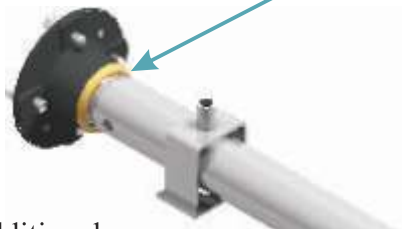

Additional:

- leaf spring
- shock absorber
- protector cup



If you are interested in our product, please give the following parameters to our sales personnel to enable us to choose the best variant for you suited to your needs:

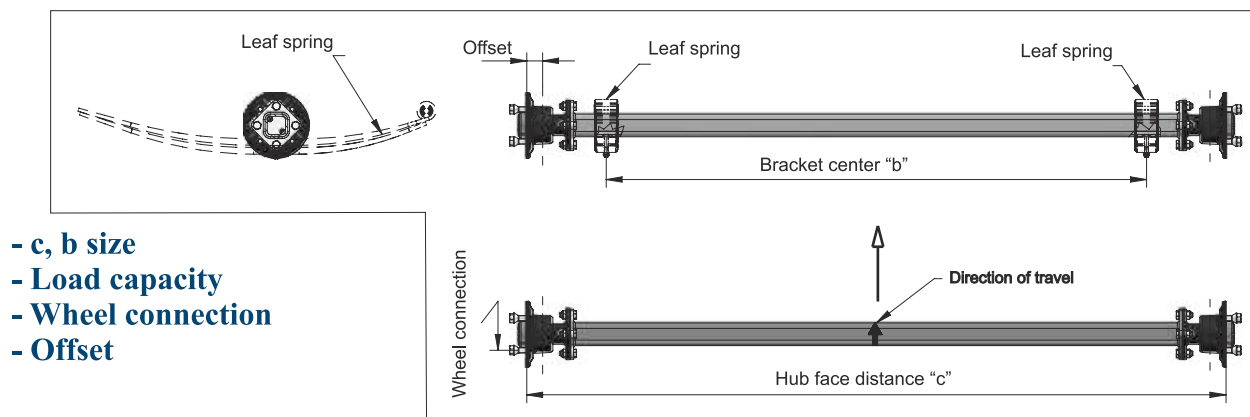

RIGID AXLE WITH AUTO-REVERSE DRUM BRAKE

Load capacity up to 1800 kg

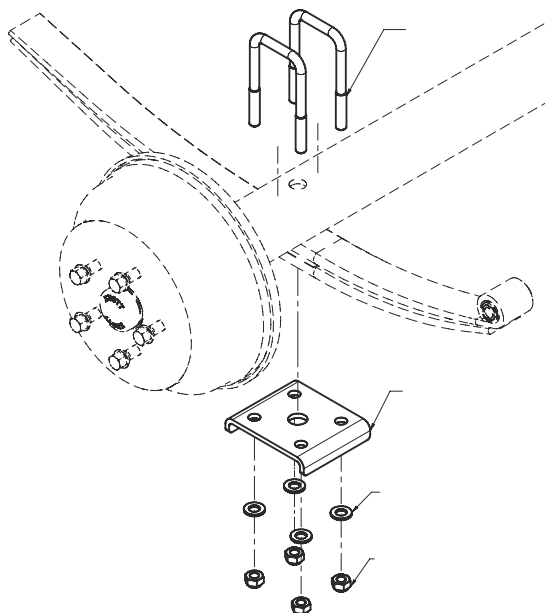

Mounting of the leaf spring



For more sizes and info please contact our sales personnel!

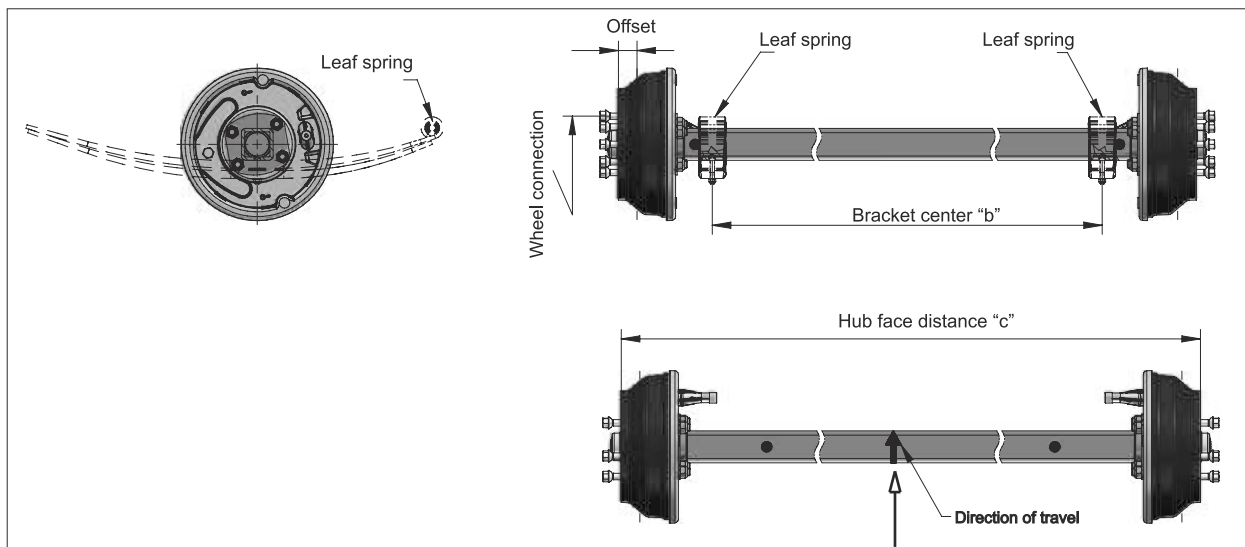

LEAF SPRINGS

Nr.	Pc	Sparte part name
1	1	Rear hanger weld-on
2	6	Rubber bushing
3	2	Shackle link
4	1	Front hanger weld-on
5	3	Shackle bolt
6	8	Washer
7	8	Hex lock nut
8	1	Leaf-spring
9	1	Trailer chassis
10	1	Axle cpl.
11	1	Rubber bench
12	1	Shock absorber holder
13	1	Shock absorber
14	2	U-Bolt
15	1	Spring bolt
16	1	Hexagon nut
17	3	Distance pipe



Mounting of the leaf spring

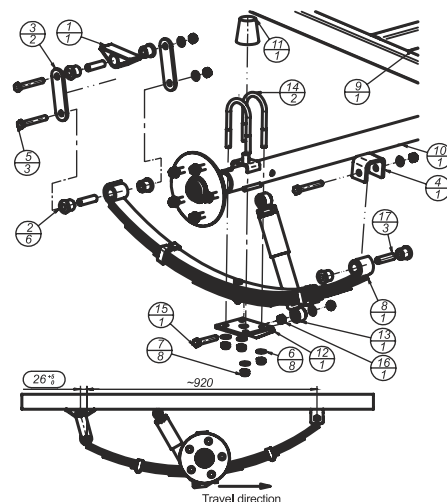

U-bolts

Use for fixing:

axles, mudguards,
rollers, glide bunk,
winches, jacks,
other trailer part elements.



Article number	H (mm)	B (mm)	Article number	H (mm)	B (mm)
6X1126.001	110	52	6X1126.022	120	100
6X1126.002	120	52	6X1126.023	150	90
6X1126.003	130	52	6X1126.024	120	82
6X1126.004	150	52	6X1126.025	140	60
6X1126.005	170	52	6X1126.026	90	40
6X1126.006	110	42	6X1126.027	80	60
6X1126.007	130	42	6X1126.028	170	60
6X1126.008	150	42	6X1126.029	160	41
6X1126.009	120	60	6X1126.030	140	106
6X1126.010	120	40	6X1126.031	180	41
6X1126.011	150	60	6X1126.032	115	61
6X1126.012	150	100	6X1126.033	80	86
6X1126.013	150	80	6X1126.034	140	42
6X1126.014	90	60	6X1126.035	140	53
6X1126.015	150	120	6X1126.036	80	74
6X1126.016	90	80	6X1126.037	70	62
6X1126.017	140	70	6X1126.038	105	62
6X1126.018	70	80	6X1126.039	70	86
6X1126.019	140	40	6X1126.040	170	42
6X1126.020	105	100	6X1126.041	130	106
6X1126.021	100	100	6X1126.042	145	56

LEAF SPRINGS FOR RIGID AXLES

Double-eye leaf-springs

Open-eye leaf-springs with flat end

Spring capacity 375 Kg

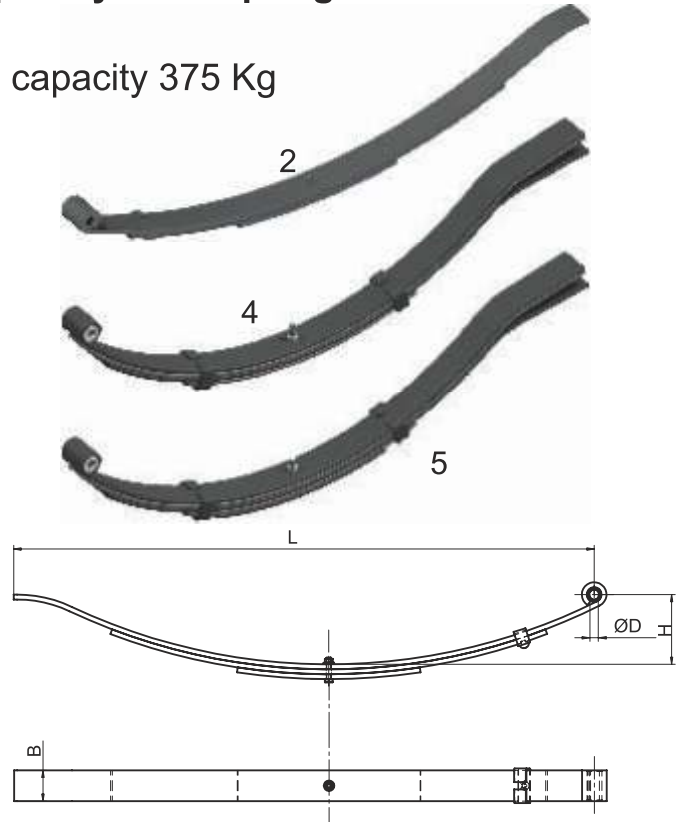
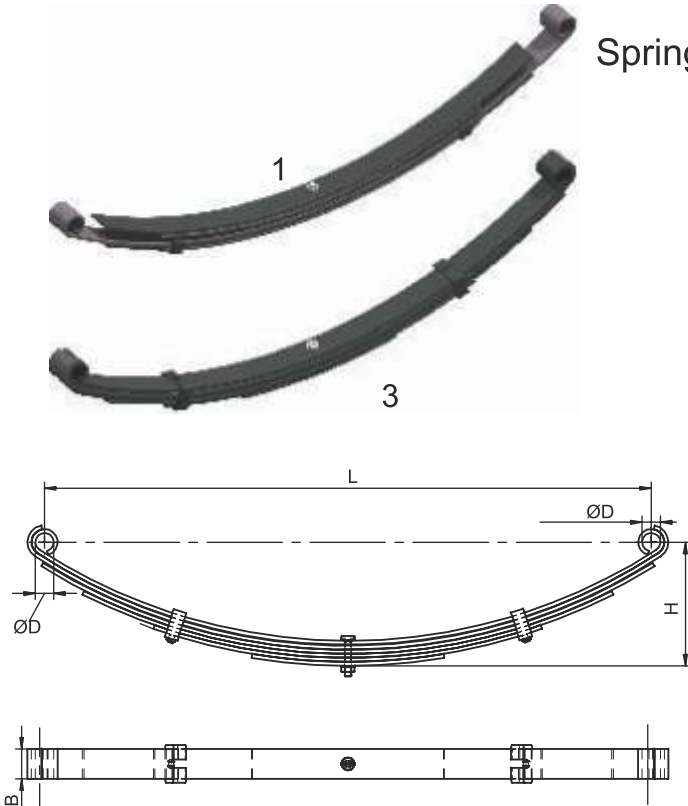

Nr.	L (mm)	B (mm)	H (mm)	ØD (mm)	Leaf (pcs)	Article number
1	920	45	170	28	6 × 6 mm	6X1356.002
2	940	50	110	16	3 × 8 mm	6X1356.004
3	920	45	188	28	6 × 6 mm	6X1356.001
4	770	45	155	12,5	4 × 6 mm	6X1356.005
5	770	45	155	12,5	5 × 6 mm	6X1356.008
6	1440	75	173	17	1 × 8-15 mm	6B6499.001
7	766	50	82	28	1 × 7-15 mm	6B4699.001
8	920	45	164,5	28	10 × 6,5 mm	6X1356.006
9	766	51	82	28	2 × 7-15 mm	6B4590.001

Spring capacity 500 Kg



Spring capacity 900 Kg

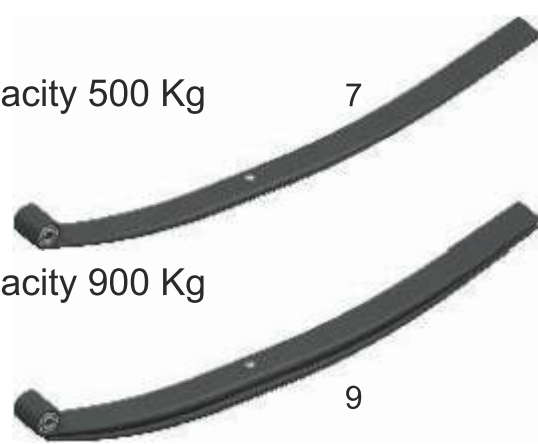

UNBRAKED RIGID TANDEM AXLE

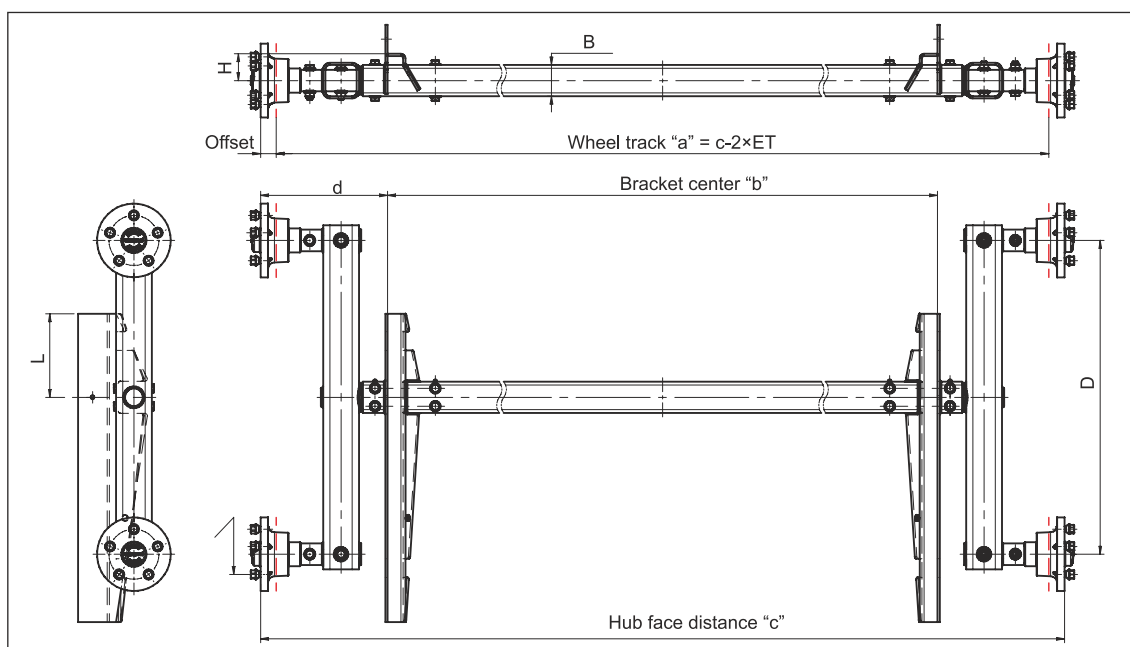

Type	GVWR (kg)	b (mm)	c (mm)	d (mm)	B (mm)	D (mm)	H (mm)	L (mm)	Offset (mm)	Wheel connection	Article number
VR 32-MV	3200	1651	2030	189,5	80×80×5	702	120	192	26 - 34,5	112×5	6A2029.001
VR 32-MV	3200	1651	2219	284	70×70×5	702	60	187	26 - 35	112×5	6AA595.001
VR 36-MV	3600	1651	2030	189,5	80×80×5	702	120	192	26 - 35	112×5	6A3540.001
VR 36-MV	3600	1651	2219	284	70×70×5	702	60	187	26 - 35	112×5	6AA727.001

SINGLE RUBBER TORSION AXLE

Product can be used for: vehicles transporting fragile goods and animals

Standard surface treatment:

- hot dip galvanization

Tube type:

- round tube

Specification of rubber torsion axle:

- soft suspension,
- it has a comfortable and precise road holding capacity,
- easy mounting,
- big load capacity.

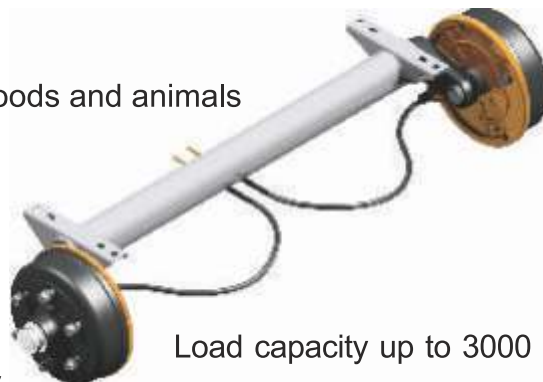

Load capacity up to 3000 kg

If you are interested in our product, please give the following parameters to our sales personnel, to enable us to choose the best variant for you to your needs.

- H, c, b size
- Load capacity
- Wheel connection
- Offset

STEEL TORSION AXLE

Can be used for: all kind of trailers

Standard surface treatment:

- hot dip galvanization

Tube type:

- round tube

Specification of steel torsion axle:

- it is less temperature dependent as the rubber torsion,
- works perfectly in harsh environment,
- has a comfortable and precise road holding capacity,
- is easy to mount,
- has big load capacity.



Unbraked axle
Load capacity up to 1000 kg

Axles
with auto-reverse drum brake
Load capacity up to 1800 kg

If you are interested in our product, please give the following parameters to our sales personnel to enable us to choose the best variant for you suited to your needs:

- H, c, b size
- Load capacity
- Wheel connection
- Offset

RIGID AXLES

FOR AGRICULTURAL MACHINERY

MECHANICAL DRUMBRAKE VERSION



Slack adjuster



UNBRAKED VERSION

Braked axle	VRB37 Carrying capacity	
  	40 Km/h	
	3700 Kg	
Unbraked axle	VR85 Carrying capacity	
  	25 Km/h	40 Km/h
	4600 Kg	4600 Kg

UNBRAKED HUB AND STUB FOR AGRICULTURAL RIGID AXLES



FNK45

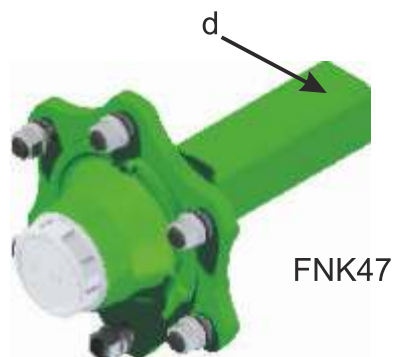

FNK47



FNK41

Type	Wheel connection	Offset (mm)	d (mm)	Load capacity (kg)	Article number
FNK45	Ø205×6, M18×1,5	0 - (- 45)	Ø50	2000	6B7410.001
FNK47	Ø205×6, M18×1,5	0 - (- 45)	60×60	2000	6B7455.001
FNK41	Ø190×8, M18×1,5	0 - (- 45)		2000	6B4433.001

UNBRAKED HALF-AXLE FOR AGRICULTURAL RIGID AXLES

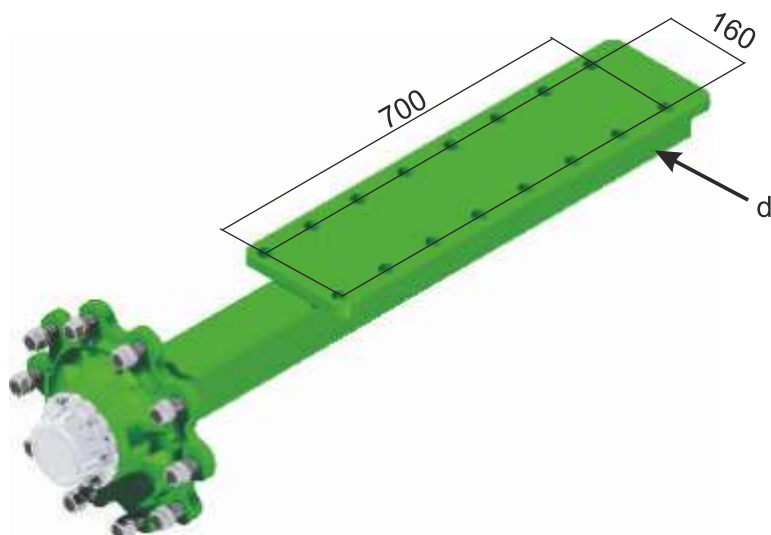

Type	Wheel connection	Offset (mm)	d (mm)	Load capacity (kg)	Article number
FNK46	Ø335×10, M22×1,5	0 - (- 45)	100×100	3500	6B7445.001

There is no trailer without us

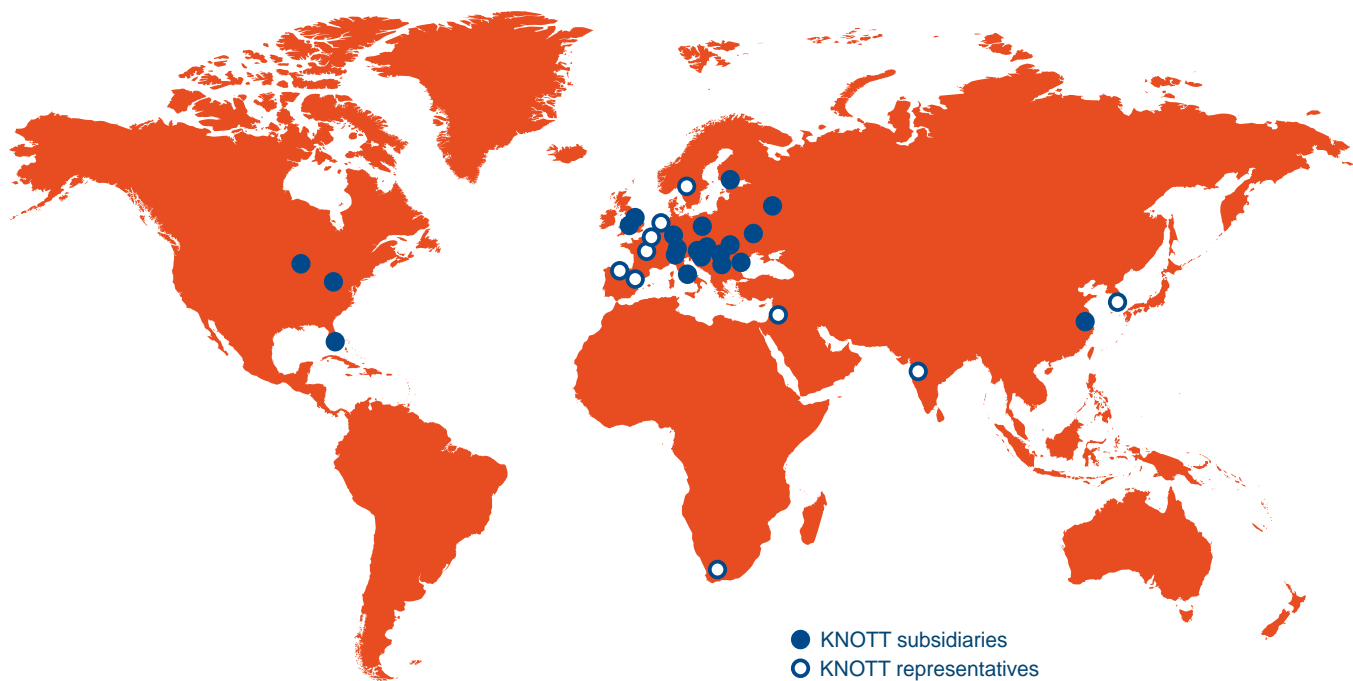

The Knott Group - global competency

The member companies of the Knott Group design, develop, produce and market braking systems for commercial and off-highway vehicles together with running gear components for trailers.

Competent, one-to-one consulting and outstanding product quality are characteristic of all the companies within the Group.

KNOTT's own production plants and branch offices are supported by a world-wide dealership network.



www.autoflex.ro

KNOTT GROUP
BRAKE AND TRAILER TECHNOLOGY

Presented by:

AUTOFLEX SRL

Tel.: (+40) 259/373-495 Fax: (+40) 259/406-748
RO-415500 Salonta - Sos. Aradului km 75+300 - Romania
web: www.autoflex.ro e-mail: info@autoflex.ro